



**Town of Boothbay  
Board of Selectmen Meeting  
Wednesday, April 14<sup>th</sup>, 2021  
7:00 PM  
Agenda**

**Board of Selectmen**

Steven C. Lewis, Chairman  
Dale C. Harmon, Vice Chairman  
Michael Tomacelli  
Desiree Scorgia  
Chuck Cunningham

**Town Manager**

Daniel Bryer

1. **Pledge of Allegiance**
  
2. **Public Hearing-** 1. Boothbay Craft Brewery, Inc., applicants Edwin Jr. & Lori Mitchell, Map R06, Lot 009, located at 301 Adams Pond Rd, Boothbay, Maine for renewal of a Restaurant Liquor license (Class I, II, III, IV).  
  
2. DECKSZ LLC, dba Lobsterman's Wharf, application for a renewal of Restaurant Liquor License (Class I, II, III, IV), Map U16, Lot 01 located at 224 Ocean Point Road, East Boothbay, ME. Also, at this same location, an application for a Special Amusement permit for DECKSZ LLC.  
  
3. DECKSZ LLC, dba Ocean Point Marina, application for a Special Amusement permit at 216 Ocean Point Rd, East Boothbay, on Map U17, Lot 44.
  
3. **Public Comment**
  
4. **Approve Minutes**
  
5. **Reports**
  
6. **Old Business-** 1. Parking Ordinance
  
7. **New Business-** 1. Boothbay Craft Brewery, Inc., applicants Edwin Jr. & Lori Mitchell, Map R06, Lot 009, located at 301 Adams Pond Rd, Boothbay, Maine for renewal of a Restaurant Liquor license (Class I, II, III, IV).



**Town of Boothbay  
Board of Selectmen Meeting  
Wednesday, April 14<sup>th</sup>, 2021  
7:00 PM  
Agenda**

**Board of Selectmen**

Steven C. Lewis, Chairman  
Dale C. Harmon, Vice Chairman  
Michael Tomacelli  
Desiree Scordia  
Chuck Cunningham

**Town Manager**

Daniel Bryer

2. DECKSZ LLC, dba Lobsterman's Wharf, application for a renewal of Restaurant Liquor License (Class I, II, III, IV), Map U16, Lot 01 located at 224 Ocean Point Road, East Boothbay, ME. Also, at this same location, an application for a Special Amusement permit for DECKSZ LLC.
  
3. DECKSZ LLC, dba Ocean Point Marina, application for a Special Amusement permit at 216 Ocean Point Rd, East Boothbay, on Map U17, Lot 44.
  
4. Emergency Management Plan
  
8. **Public Comment**
  
9. **Review Warrants**
  
10. **Adjourn Meeting**

## **ROUTE 27 PARKING ORDINANCE**

- I. Authority:** This parking ordinance is adopted pursuant to 30-A M.R.S. § 3009(1)(C).
- II. Purpose:** This Ordinance is designed to protect public health and welfare by regulating the parking of motor vehicles on Route 27 a/k/a Wiscasset Road in Boothbay. Unrestricted parking on Route 27 creates traffic congestion, impedes winter maintenance and is dangerous to pedestrians and motorists. The purpose of this Ordinance is to reduce these dangers and to regulate parking as necessary to protect public health, safety and welfare.
- III. Definitions:** Words used in this Ordinance shall be defined in accordance with 29-A M.R.S. § 101; any undefined word shall have its common, ordinary meaning.
- IV. Regulated Area:** When signs are erected giving notice thereof, no person shall park any motor vehicle at any time on Route 27 (a/k/a Wiscasset Road) in Boothbay for the stretch of Route 27 that runs from (a) the northerly intersection of Adams Pond Road and Route 27 to (b) the southerly intersection of Adams Pond Road and Route 27.
- V. Exceptions:** This Ordinance does not apply to motor vehicles that are parked in prohibited areas for the following reasons: (a) mechanical problems or breakdowns; (b) emergency situations; or (c) maintenance, construction, repair or installation of utilities in the public way by any State or municipal agency or utility company.
- VI. Prima Facie Evidence of Operation:** No person shall cause, allow or permit a motor vehicle registered in his or her name to park in violation of this Ordinance. The fact that a motor vehicle is unlawfully parked shall be prima facie evidence of the unlawful parking of such vehicle by the person in whose name such vehicle is registered.
- VII. Enforcement and Penalties:** This Ordinance may be enforced by the Town's duly authorized law enforcement provider (currently Lincoln County Sheriff's Department), a constable of the Town of Boothbay, and any person specifically authorized by formal vote of the Board of Selectmen to enforce this Ordinance. A violation of this Ordinance is a civil violation punishable by a fine of \$75 and shall be prosecuted, if necessary, in District Court. Any person

charged with a violation of this Ordinance may waive court action by paying a waiver fee of \$35 to the Town Clerk within 14 days of the violation. All fines and waiver fees shall accrue to the benefit of the Town.

**VIII. Severability:** In the event that any portion of this Ordinance is found by a court of competent jurisdiction to be invalid, the remaining provisions shall continue in full force and effect.

**IX. Effective Date:** This Ordinance shall become effective when adopted by a majority of the Board of Selectmen.

Date adopted: April \_\_\_\_, 2021



STATE OF MAINE  
 DEPARTMENT OF ADMINISTRATIVE AND FINANCIAL SERVICES  
 BUREAU OF ALCOHOLIC BEVERAGES AND LOTTERY OPERATIONS  
 DIVISION OF LIQUOR LICENSING AND ENFORCEMENT

TELEPHONE: (207) 624-7220  
 FAX: (207) 287-3434  
 EMAIL INQUIRIES: [maineliqor@maine.gov](mailto:maineliqor@maine.gov)

Thank you for your interested in becoming a licensed establishment to sell and serve alcoholic beverages in Maine. To avoid any delay in the processing of your application and the subsequent issuance of your liquor license, please use the following checklist to assist you in completing the application. If you are renewing your license, this checklist is useful as well.

- Your application has been completed in its entirety and is legible. For a renewal, please submit your application 30 days prior to the expiration date of your liquor license.
- Your application is signed and dated by a duly authorized person.
- The application is signed and approved by the Town or City Municipal Officers or County Commissioners.
- The license fee submitted is for the correct fee for the license class for which you are applying and includes the \$10.00 filing fee.
  - The check must be made payable to "Treasurer, State of Maine"; both the license and filing fees can be submitted on one check.
  - If the licensee/applicant(s) is in an unorganized township, the application must be approved by the County Commissioners and the \$10.00 filing fee must be paid to them. Please be sure to include a copy of the receipt of payment with your application.
- For a renewal, the dollar amount of your gross income for food, liquor and guest rooms, if applicable must be completed – see Section I.1
- A diagram of the facility to be licensed must accompany **all** applications whether for a new license or the renewal of an existing license
- If you are a registered business entity with the Maine Secretary of State's office like a corporation or a limited liability company, you must complete Section VII of the application. This does not need to be completed if you are a sole proprietor.
- Have you applied for other required licensing from other state and federal agencies? See attached list.

**Important** – all applications whether for a new license or to renew an existing license for an on-premises liquor licenses must contact their Municipal Officials or the County Commissioners in unincorporated places to have their application approved and signed prior to submitting it to the Bureau for further consideration.

The address to send your completed application to:

1. Mailing address:  
 Bureau of Alcoholic Beverages and Lottery Operations  
 Division of Liquor Licensing and Enforcement  
 8 State House Station  
 Augusta, ME 04333-0008
2. Courier/overnight address:  
 Bureau of Alcoholic Beverages and Lottery Operations  
 Division of Liquor Licensing and Enforcement  
 19 Union Street, Suite 301-B  
 Augusta, ME 04330

**The following licenses/permits may be required prior to be licensing as an on-premises licensee with the Bureau**

<b>Obtained ✓</b>	<b>License/Permit</b>	<b>State/Federal Agency to Contact</b>	<b>Telephone Number</b>	<b>Physical Location</b>
	Seller Certificate or Sales Tax Number	Maine Revenue Services <a href="http://www.maine.gov/revenue">www.maine.gov/revenue</a>	(207) 624-9693	51 Commerce Dr, Augusta
	Health License	Health and Human Services <a href="http://www.maine.gov/dhhs">www.maine.gov/dhhs</a>	(207) 287-5671	286 Water St. 3 <sup>rd</sup> floor, Augusta
	Victualer's License	Municipality where premise is located.	Contact your town office or county office	Contact your town office or county office
	Shellfish License	Marine Recourses <a href="http://www.maine.gov/dmr">www.maine.gov/dmr</a>	(207) 624-6550	<ul style="list-style-type: none"> <li>• 32 Blossom Lane, Augusta</li> <li>• 194 McKown Point Rd, West Boothbay Harbor</li> <li>• Lamoine State Park, Lamoine</li> <li>• 650 State St, Bangor</li> <li>• 317 Whitneyville Rd, Jonesboro</li> </ul>
	Dance or Entertainment License	Fire Marshall's Office <a href="http://www.maine.gov/dps/fmo">www.maine.gov/dps/fmo</a>	(207) 626-3882	45 Commerce Drive, Suite 1, Augusta
	Federal I.D. Number	<a href="http://www.irs.gov">www.irs.gov</a>	(800) 829-4933	
	Legal business names for corporations and limited liability companies and "Doing Business As" Names (assumed names)	Secretary of State, Bureau of Corporations, Elections and Commissions <a href="http://www.maine.gov/sos/cec">www.maine.gov/sos/cec</a>	(207) 624-7752	111 Sewall St, 3 <sup>rd</sup> Fl. Augusta
	Retail Beverage Alcohol Dealers Permit	Alcohol and Tobacco Tax and Trade Bureau (TTB) <a href="https://www.ttb.gov/nrc/retail-beverage-alcohol-dealers">https://www.ttb.gov/nrc/retail-beverage-alcohol-dealers</a>	(877) 882-3277	



4. Indicate the type of license applying for: (choose only one)

- |  |  |   |
|--|--|---|
| <input checked="" type="checkbox"/> Restaurant<br>(Class I, II, III, IV)   | <input type="checkbox"/> Class A Restaurant/Lounge<br>(Class XI)         | <input type="checkbox"/> Class A Lounge<br>(Class X)  |
| <input type="checkbox"/> Hotel<br>(Class I, II, III, IV)   | <input type="checkbox"/> Hotel – Food Optional<br>(Class I-A)            | <input type="checkbox"/> Bed & Breakfast<br>(Class V) |
| <input type="checkbox"/> Golf Course (included optional licenses, please check if apply)<br>(Class I, II, III, IV) | <input type="checkbox"/> Auxiliary                                       | <input type="checkbox"/> Mobile Cart                  |
| <input type="checkbox"/> Tavern<br>(Class IV)  | <input type="checkbox"/> Other: _____                                    |   |
| <input type="checkbox"/> Qualified Caterer   | <input type="checkbox"/> Self-Sponsored Events (Qualified Caterers Only) |   |

*Refer to Section V for the License Fee Schedule on page 9*

5. Business records are located at the following address:

301 Adams Pond Road, Boothbay

---

6. Is the licensee/applicant(s) citizens of the United States?  Yes  No
7. Is the licensee/applicant(s) a resident of the State of Maine?  Yes  No

**NOTE: Applicants that are not citizens of the United States are required to file for the license as a business entity.**

8. Is licensee/applicant(s) a business entity like a corporation or limited liability company?

Yes  No If Yes, complete Section VII at the end of this application

9. For a licensee/applicant who is a business entity as noted in Section I, does any officer, director, member, manager, shareholder or partner have in any way an interest, directly or indirectly, in their capacity in any other business entity which is a holder of a wholesaler license granted by the State of Maine?

Yes  No

Not applicable – licensee/applicant(s) is a sole proprietor



10. Is the licensee or applicant for a license receiving, directly or indirectly, any money, credit, thing of value, endorsement of commercial paper, guarantee of credit or financial assistance of any sort from any person or entity within or without the State, if the person or entity is engaged, directly or indirectly, in the manufacture, distribution, wholesale sale, storage or transportation of liquor.

Yes  No

If yes, please provide details: \_\_\_\_\_  
 \_\_\_\_\_

11. Do you own or have any interest in any another Maine Liquor License?  Yes  No

If yes, please list license number, business name, and complete physical location address: (attach additional pages as needed using the same format)

Name of Business	License Number	Complete Physical Address

12. List name, date of birth, place of birth for all applicants including any manager(s) employed by the licensee/applicant. Provide maiden name, if married. (attach additional pages as needed using the same format)

Full Name	DOB	Place of Birth
Edwin Mitchell Jr	06/10/1966	Boothbay Harbor
Lori Ann Mitchell	09/18/1966	Danvers, MA

Residence address on all the above for previous 5 years

Name: Edwin Mitchell Jr      Address: Boothbay

Name: Lori Mitchell      Address: Boothbay

Name:      Address:

Name:      Address:

13. Will any law enforcement officer directly benefit financially from this license, if issued?

Yes  No

If Yes, provide name of law enforcement officer and department where employed:

\_\_\_\_\_

14. Has the licensee/applicant(s) ever been convicted of any violation of the liquor laws in Maine or any State of the United States?  Yes  No

If Yes, please provide the following information and attach additional pages as needed using the same format.

Name: \_\_\_\_\_ Date of Conviction: \_\_\_\_\_

Offense: \_\_\_\_\_ Location: \_\_\_\_\_

Disposition: \_\_\_\_\_

15. Has the licensee/applicant(s) ever been convicted of any violation of any law, other than minor traffic violations, in Maine or any State of the United States?  Yes  No

If Yes, please provide the following information and attach additional pages as needed using the same format.

Name: \_\_\_\_\_ Date of Conviction: \_\_\_\_\_

Offense: \_\_\_\_\_ Location: \_\_\_\_\_

Disposition: \_\_\_\_\_

16. Has the licensee/applicant(s) formerly held a Maine liquor license?  Yes  No

17. Does the licensee/applicant(s) own the premises?  Yes  No

If No, please provide the name and address of the owner:

\_\_\_\_\_

18. If you are applying for a liquor license for a Hotel or Bed & Breakfast, please provide the number of guest rooms available: 0.00

19. Please describe in detail the area(s) within the premises to be licensed. This description is in addition to the diagram in Section VI. (Use additional pages as needed)

---

---

---

---

20. What is the distance from the premises to the **nearest** school, school dormitory, church, chapel or parish house, measured from the main entrance of the premises to the main entrance of the school, school dormitory, church, chapel or parish house by the ordinary course of travel?

Name: Church

Distance: 2,000.00

**Section II: Signature of Applicant(s)**

By signing this application, the licensee/applicant understands that false statements made on this application are punishable by law. Knowingly supplying false information on this application is a Class D Offense under Maine's Criminal Code, punishable by confinement of up to one year, or by monetary fine of up to \$2,000 or by both.

*Please sign and date in blue ink.*

Dated: 3/16/21

  
Signature of Duly Authorized Person

Edw M. MITCHELL JR.  
Printed Name Duly Authorized Person

  
Signature of Duly Authorized Person

Lois A. MITCHELL  
Printed Name of Duly Authorized Person

**Section III: For use by Municipal Officers and County Commissioners only**

The undersigned hereby certifies that we have complied with the process outlined in 28-A M.R.S. §653 and approve this on-premises liquor license application.

Dated: \_\_\_\_\_

Who is approving this application?  Municipal Officers of \_\_\_\_\_

County Commissioners of \_\_\_\_\_ County

- Please Note:** The Municipal Officers or County Commissioners must confirm that the records of Local Option Votes have been verified that allows this type of establishment to be licensed by the Bureau for the type of alcohol to be sold for the appropriate days of the week. Please check this box to indicate this verification was completed.

Signature of Officials	Printed Name and Title

**This Application will Expire 60 Days from the date of  
Municipal or County Approval unless submitted to the Bureau**

Included below is the section of Maine’s liquor laws regarding the approval process by the municipalities or the county commissioners. This is provided as a courtesy only and may not reflect the law in effect at the time of application. Please see <http://www.mainelegislature.org/legis/statutes/28-A/title28-Asec653.html>

§653. Hearings; bureau review; appeal

**1. Hearings.** The municipal officers or, in the case of unincorporated places, the county commissioners of the county in which the unincorporated place is located, may hold a public hearing for the consideration of applications for new on-premises licenses and applications for transfer of location of existing on-premises licenses. The municipal officers or county commissioners may hold a public hearing for the consideration of requests for renewal of licenses, except that when an applicant has held a license for the prior 5 years and a complaint has not been filed against the applicant within that time, the applicant may request a waiver of the hearing.

A. The bureau shall prepare and supply application forms.

**B.** The municipal officers or the county commissioners, as the case may be, shall provide public notice of any hearing held under this section by causing a notice, at the applicant's prepaid expense, stating the name and place of hearing, to appear on at least 3 consecutive days before the date of hearing in a daily newspaper having general circulation in the municipality where the premises are located or one week before the date of the hearing in a weekly newspaper having general circulation in the municipality where the premises are located.

**C.** If the municipal officers or the county commissioners, as the case may be, fail to take final action on an application for a new on-premises license or transfer of the location of an existing on-premises license within 60 days of the filing of an application, the application is deemed approved and ready for action by the bureau. For purposes of this paragraph, the date of filing of the application is the date the application is received by the municipal officers or county commissioners. This paragraph applies to all applications pending before municipal officers or county commissioners as of the effective date of this paragraph as well as all applications filed on or after the effective date of this paragraph. This paragraph applies to an existing on-premises license that has been extended pending renewal. The municipal officers or the county commissioners shall take final action on an on-premises license that has been extended pending renewal within 120 days of the filing of the application.

**D.** If an application is approved by the municipal officers or the county commissioners but the bureau finds, after inspection of the premises and the records of the applicant, that the applicant does not qualify for the class of license applied for, the bureau shall notify the applicant of that fact in writing. The bureau shall give the applicant 30 days to file an amended application for the appropriate class of license, accompanied by any additional license fee, with the municipal officers or county commissioners, as the case may be. If the applicant fails to file an amended application within 30 days, the original application must be denied by the bureau. The bureau shall notify the applicant in writing of its decision to deny the application including the reasons for the denial and the rights of appeal of the applicant.

**2. Findings.** In granting or denying an application, the municipal officers or the county commissioners shall indicate the reasons for their decision and provide a copy to the applicant. A license may be denied on one or more of the following grounds:

**A.** Conviction of the applicant of any Class A, Class B or Class C crime;

**B.** Noncompliance of the licensed premises or its use with any local zoning ordinance or other land use ordinance not directly related to liquor control;

**C.** Conditions of record such as waste disposal violations, health or safety violations or repeated parking or traffic violations on or in the vicinity of the licensed premises and caused by persons patronizing or employed by the licensed premises or other such conditions caused by persons patronizing or employed by the licensed premises that unreasonably disturb, interfere with or affect the ability of persons or businesses residing or located in the vicinity of the licensed premises to use their property in a reasonable manner;

**D.** Repeated incidents of record of breaches of the peace, disorderly conduct, vandalism or other violations of law on or in the vicinity of the licensed premises and caused by persons patronizing or employed by the licensed premises:

**D-1.** Failure to obtain, or comply with the provisions of, a permit for music, dancing or entertainment required by a municipality or, in the case of an unincorporated place, the county commissioners;

**E.** A violation of any provision of this Title;

**F.** A determination by the municipal officers or county commissioners that the purpose of the application is to circumvent the provisions of section 601; and

G. After September 1, 2010, server training, in a program certified by the bureau and required by local ordinance, has not been completed by individuals who serve alcoholic beverages.

**3. Appeal to bureau.** Any applicant aggrieved by the decision of the municipal officers or county commissioners under this section may appeal to the bureau within 15 days of the receipt of the written decision of the municipal officers or county commissioners. The bureau shall hold a public hearing in the city, town or unincorporated place where the premises are situated. In acting on such an appeal, the bureau may consider all licensure requirements and findings referred to in subsection 2.

A. Repealed

B. If the decision appealed from is an application denial, the bureau may issue the license only if it finds by clear and convincing evidence that the decision was without justifiable cause.

**4. Repealed**

**5. Appeal to District Court.** Any person or governmental entity aggrieved by a bureau decision under this section may appeal the decision to the District Court within 30 days of receipt of the written decision of the bureau.

An applicant who files an appeal or who has an appeal pending shall pay the annual license fee the applicant would otherwise pay. Upon resolution of the appeal, if an applicant's license renewal is denied, the bureau shall refund the applicant the prorated amount of the unused license fee.

#### **Section IV: Terms and Conditions of Licensure as an Establishment that sells liquor for on-premises consumption in Maine**

- The licensee/applicant(s) agrees to be bound by and comply with the laws, rules and instructions promulgated by the Bureau.
- The licensee/applicant(s) agrees to maintain accurate records related to an on-premise license as required by the law, rules and instructions promulgated or issued by the Bureau if a license is issued as a result of this application.
  - The licensee/applicant(s) authorizes the Bureau to obtain and examine all books, records and tax returns pertaining to the business, for which this liquor license is requested, and also any books, records and returns during the year in which any liquor license is in effect.
- Any change in the licensee's/applicant's licensed premises as defined in this application must be approved by the Bureau in advance.
- All new applicants must apply to the Alcohol and Tobacco Tax and Trade Bureau (TTB) for its [Retail Beverage Alcohol Dealers](https://www.ttb.gov/nrc/retail-beverage-alcohol-dealers) permit. See the TTB's website at <https://www.ttb.gov/nrc/retail-beverage-alcohol-dealers> for more information.

## Section V: Fee Schedule

**Filing fee required.** In addition to the license fees listed below, a filing fee of \$10.00 must be included with all applications.

**Please note:** For Licensees/Applicants in unorganized territories in Maine, the \$10.00 filing fee must be paid directly to County Treasurer. All applications received by the Bureau from licensees/applicants in unorganized territories must submit proof of payment was made to the County Treasurer together with the application.

<b>Class of License</b>	<b>Type of liquor/Establishments included</b>	<b>Fee</b>
<b>Class I</b>	<b>For the sale of liquor (malt liquor, wine and spirits)</b> This class includes: Airlines; Civic Auditoriums; Class A Restaurants; Clubs with catering privileges; Dining Cars; Golf Courses; Hotels; Indoor Ice-Skating Clubs; Indoor Tennis Clubs; Vessels; Qualified Caterers	\$ 900.00
<b>Class I-A</b>	<b>For the sale of liquor (malt liquor, wine and spirits)</b> This class includes only hotels that do not serve three meals a day.	\$1,100.00
<b>Class II</b>	<b>For the Sale of Spirits Only</b> This class includes: Airlines; Civic Auditoriums; Class A Restaurants; Clubs with catering privileges; Dining Cars; Golf Courses; Hotels; Indoor Ice-Skating Clubs; Indoor Tennis Clubs; and Vessels.	\$ 550.00
<b>Class III</b>	<b>For the Sale of Wine Only</b> This class includes: Airlines; Civic Auditoriums; Class A Restaurants; Clubs with catering privileges; Dining Cars; Golf Courses; Hotels; Indoor Ice-Skating Clubs; Indoor Tennis Clubs; Restaurants; Vessels; Pool Halls; and Bed and Breakfasts.	\$ 220.00
<b>Class IV</b>	<b>For the Sale of Malt Liquor Only</b> This class includes: Airlines; Civic Auditoriums; Class A Restaurants; Clubs with catering privileges; Dining Cars; Golf Courses; Hotels; Indoor Ice-Skating Clubs; Indoor Tennis Clubs; Restaurants; Taverns; Pool Halls; and Bed and Breakfasts.	\$ 220.00
<b>Class III and IV</b>	<b>For the Sale of Malt Liquor and Wine Only</b> This class includes: Airlines; Civic Auditoriums; Class A Restaurants; Clubs with catering privileges; Dining Cars; Golf Courses; Hotels; Indoor Ice-Skating Clubs; Indoor Tennis Clubs; Restaurants; Vessels; Pool Halls; and Bed and Breakfasts.	\$ 440.00
<b>Class V</b>	<b>For the sale of liquor (malt liquor, wine and spirits)</b> This class includes only a Club without catering privileges.	\$ 495.00
<b>Class X</b>	<b>For the sale of liquor (malt liquor, wine and spirits)</b> This class includes only a Class A Lounge	\$2,200.00
<b>Class XI</b>	<b>For the sale of liquor (malt liquor, wine and spirits)</b> This class includes only a Restaurant Lounge	\$1,500.00

**Section VI Premises Floor Plan**

In an effort to clearly define your license premise and the areas that consumption and storage of liquor authorized by your license type is allowed, the Bureau requires all applications to include a diagram of the premise to be licensed.

Diagrams should be submitted on this form and should be as accurate as possible. Be sure to label the following areas: entrances, office area, coolers, storage areas, display cases, shelves, restroom, point of sale area, area for on-premise consumption, dining rooms, event/function rooms, lounges, outside area/decks or any other areas on the premise that you are requesting approval. Attached an additional page as needed to fully describe the premise.

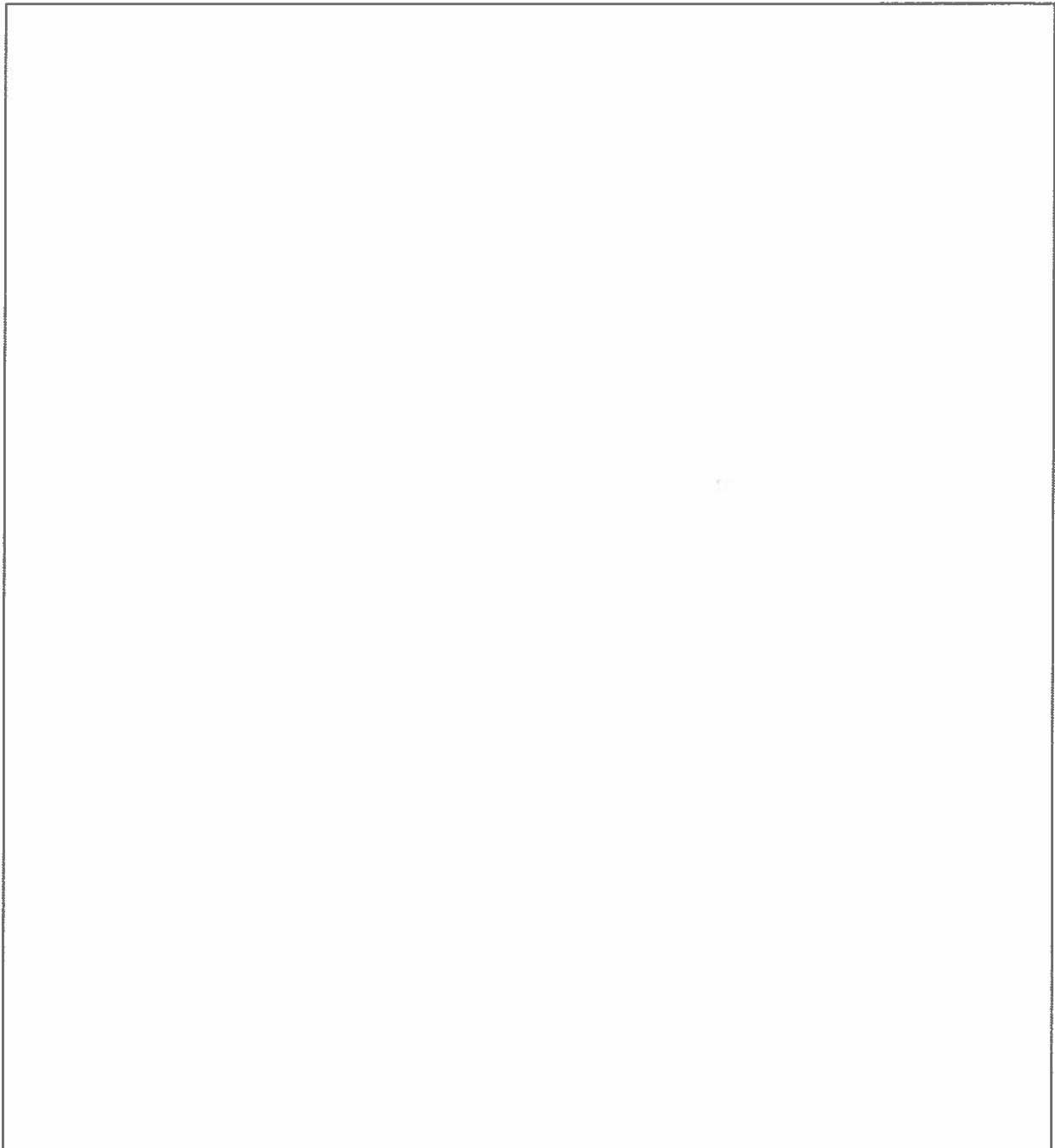



**Section VII: Required Additional Information for a Licensee/Applicant for an On-Premises Liquor License Who are Legal Business Entities**

Questions 1 to 4 of this part of the application must match information in Section I of the application above and match the information on file with the Maine Secretary of State's office. If you have questions regarding your legal entity name or DBA, please call the Secretary of State's office at (207) 624-7752.

*All Questions Must Be Answered Completely. Please print legibly.*

1. Exact legal name: Boothbay Craft Brewery, Inc
2. Doing Business As, if any: Restaurant
3. Date of filing with Secretary of State: 03/15/2021 State in which you are formed: Maine
4. If not a Maine business entity, date on which you were authorized to transact business in the State of Maine:  
\_\_\_\_\_
5. List the name and addresses for previous 5 years, birth dates, titles of officers, directors, managers, members or partners and the percentage ownership any person listed: (attached additional pages as needed)

Name	Address (5 Years)	Date of Birth	Title	Percentage of Ownership
Edwin Mitchell Jr	301 Adams Pond Rd	06/10/1966	Owner	50.0000
Lori Mitchell	301 Adams Pond Rd	09/18/1966	Owner	50.0000

(Ownership in non-publicly traded companies must add up to 100%.)



4. Indicate the type of license applying for: (choose only one)

- |  |   |   |
|--|---|---|
| <input type="checkbox"/> Restaurant<br>(Class I, II, III, IV)  | <input checked="" type="checkbox"/> Class A Restaurant/Lounge<br>(Class XI) | <input type="checkbox"/> Class A Lounge<br>(Class X)  |
| <input type="checkbox"/> Hotel<br>(Class I, II, III, IV)   | <input type="checkbox"/> Hotel – Food Optional<br>(Class I-A)               | <input type="checkbox"/> Bed & Breakfast<br>(Class V) |
| <input type="checkbox"/> Golf Course (included optional licenses, please check if apply)<br>(Class I, II, III, IV) | <input type="checkbox"/> Auxiliary  | <input type="checkbox"/> Mobile Cart                  |
| <input type="checkbox"/> Tavern<br>(Class IV)  | <input type="checkbox"/> Other: _____                                       |   |
| <input type="checkbox"/> Qualified Caterer   | <input type="checkbox"/> Self-Sponsored Events (Qualified Caterers Only)    |   |

Refer to Section V for the License Fee Schedule on page 9

5. Business records are located at the following address:

224 OCEAN POINT RD

---

6. Is the licensee/applicant(s) citizens of the United States?  Yes  No
7. Is the licensee/applicant(s) a resident of the State of Maine?  Yes  No

**NOTE: Applicants that are not citizens of the United States are required to file for the license as a business entity.**

8. Is licensee/applicant(s) a business entity like a corporation or limited liability company?

Yes  No If Yes, complete Section VII at the end of this application

9. For a licensee/applicant who is a business entity as noted in Section I, does any officer, director, member, manager, shareholder or partner have in any way an interest, directly or indirectly, in their capacity in any other business entity which is a holder of a wholesaler license granted by the State of Maine?

Yes  No

Not applicable – licensee/applicant(s) is a sole proprietor

10. Is the licensee or applicant for a license receiving, directly or indirectly, any money, credit, thing of value, endorsement of commercial paper, guarantee of credit or financial assistance of any sort from any person or entity within or without the State, if the person or entity is engaged, directly or indirectly, in the manufacture, distribution, wholesale sale, storage or transportation of liquor.

Yes  No

If yes, please provide details: \_\_\_\_\_  
 \_\_\_\_\_

11. Do you own or have any interest in any another Maine Liquor License?  Yes  No

If yes, please list license number, business name, and complete physical location address: (attach additional pages as needed using the same format)

Name of Business	License Number	Complete Physical Address

12. List name, date of birth, place of birth for all applicants including any manager(s) employed by the licensee/applicant. Provide maiden name, if married. (attach additional pages as needed using the same format)

Full Name	DOB	Place of Birth
DANIEL F. MILLER	11/11/1960	WEYMOUTH, MA
EILEEN C. MILLER	08/14/1961	NEW YORK, NY

Residence address on all the above for previous 5 years	
Name	Address:
DANIEL F. MILLER	683 BISCY RD, BREMEN, ME 04551
EILEEN C. MILLER	683 BISCY RD, BREMEN, ME 04551
Name	Address:
Name	Address:

13. Will any law enforcement officer directly benefit financially from this license, if issued?

Yes  No

If Yes, provide name of law enforcement officer and department where employed:

\_\_\_\_\_

14. Has the licensee/applicant(s) ever been convicted of any violation of the liquor laws in Maine or any State of the United States?  Yes  No

If Yes, please provide the following information and attach additional pages as needed using the same format.

Name: \_\_\_\_\_ Date of Conviction: \_\_\_\_\_

Offense: \_\_\_\_\_ Location: \_\_\_\_\_

Disposition: \_\_\_\_\_

15. Has the licensee/applicant(s) ever been convicted of any violation of any law, other than minor traffic violations, in Maine or any State of the United States?  Yes  No

If Yes, please provide the following information and attach additional pages as needed using the same format.

Name: \_\_\_\_\_ Date of Conviction: \_\_\_\_\_

Offense: \_\_\_\_\_ Location: \_\_\_\_\_

Disposition: \_\_\_\_\_

16. Has the licensee/applicant(s) formerly held a Maine liquor license?  Yes  No

17. Does the licensee/applicant(s) own the premises?  Yes  No

If No, please provide the name and address of the owner:

\_\_\_\_\_

18. If you are applying for a liquor license for a Hotel or Bed & Breakfast, please provide the number of guest rooms available: \_\_\_\_\_

19. Please describe in detail the area(s) within the premises to be licensed. This description is in addition to the diagram in Section VI. (Use additional pages as needed)

WATERFRONT RESTAURANT D.B.A. LOBSTERMAN'S WHARF. FOOD IS ORDERED  
AND PICKED UP AT WINDOW AND DRINKS ARE SERVED AT THE BAR. FOOD PREP AND  
SERVICE AREA, BAR AND DINING TABLES ARE ALL ENCLOSED BY RAILING AROUND  
PERIMETER OF WHARF. ALL FOOD AND DRINK MUST BE CONSUMED ON PREMISES.

20. What is the distance from the premises to the **nearest** school, school dormitory, church, chapel or parish house, measured from the main entrance of the premises to the main entrance of the school, school dormitory, church, chapel or parish house by the ordinary course of travel?

Name: BAPTIST CHURCH

Distance: 300.00

**Section II: Signature of Applicant(s)**

By signing this application, the licensee/applicant understands that false statements made on this application are punishable by law. Knowingly supplying false information on this application is a Class D Offense under Maine's Criminal Code, punishable by confinement of up to one year, or by monetary fine of up to \$2,000 or by both.

Please sign and date in blue ink.

Dated: 3/21/2021

  
Signature of Duly Authorized Person

Daniel F. Miller  
Printed Name Duly Authorized Person

  
Signature of Duly Authorized Person

Eileen C. Miller  
Printed Name of Duly Authorized Person

**Section III: For use by Municipal Officers and County Commissioners only**

The undersigned hereby certifies that we have complied with the process outlined in 28-A M.R.S. §653 and approve this on-premises liquor license application.

Dated: \_\_\_\_\_

Who is approving this application?  Municipal Officers of \_\_\_\_\_

County Commissioners of \_\_\_\_\_ County

- Please Note:** The Municipal Officers or County Commissioners must confirm that the records of Local Option Votes have been verified that allows this type of establishment to be licensed by the Bureau for the type of alcohol to be sold for the appropriate days of the week. Please check this box to indicate this verification was completed.

Signature of Officials	Printed Name and Title

**This Application will Expire 60 Days from the date of Municipal or County Approval unless submitted to the Bureau**

Included below is the section of Maine’s liquor laws regarding the approval process by the municipalities or the county commissioners. This is provided as a courtesy only and may not reflect the law in effect at the time of application. Please see <http://www.mainelegislature.org/legis/statutes/28-A/title28-Asec653.html>

§653. Hearings; bureau review; appeal

**1. Hearings.** The municipal officers or, in the case of unincorporated places, the county commissioners of the county in which the unincorporated place is located, may hold a public hearing for the consideration of applications for new on-premises licenses and applications for transfer of location of existing on-premises licenses. The municipal officers or county commissioners may hold a public hearing for the consideration of requests for renewal of licenses, except that when an applicant has held a license for the prior 5 years and a complaint has not been filed against the applicant within that time, the applicant may request a waiver of the hearing.

A. The bureau shall prepare and supply application forms.

**B.** The municipal officers or the county commissioners, as the case may be, shall provide public notice of any hearing held under this section by causing a notice, at the applicant's prepaid expense, stating the name and place of hearing, to appear on at least 3 consecutive days before the date of hearing in a daily newspaper having general circulation in the municipality where the premises are located or one week before the date of the hearing in a weekly newspaper having general circulation in the municipality where the premises are located.

**C.** If the municipal officers or the county commissioners, as the case may be, fail to take final action on an application for a new on-premises license or transfer of the location of an existing on-premises license within 60 days of the filing of an application, the application is deemed approved and ready for action by the bureau. For purposes of this paragraph, the date of filing of the application is the date the application is received by the municipal officers or county commissioners. This paragraph applies to all applications pending before municipal officers or county commissioners as of the effective date of this paragraph as well as all applications filed on or after the effective date of this paragraph. This paragraph applies to an existing on-premises license that has been extended pending renewal. The municipal officers or the county commissioners shall take final action on an on-premises license that has been extended pending renewal within 120 days of the filing of the application.

**D.** If an application is approved by the municipal officers or the county commissioners but the bureau finds, after inspection of the premises and the records of the applicant, that the applicant does not qualify for the class of license applied for, the bureau shall notify the applicant of that fact in writing. The bureau shall give the applicant 30 days to file an amended application for the appropriate class of license, accompanied by any additional license fee, with the municipal officers or county commissioners, as the case may be. If the applicant fails to file an amended application within 30 days, the original application must be denied by the bureau. The bureau shall notify the applicant in writing of its decision to deny the application including the reasons for the denial and the rights of appeal of the applicant.

**2. Findings.** In granting or denying an application, the municipal officers or the county commissioners shall indicate the reasons for their decision and provide a copy to the applicant. A license may be denied on one or more of the following grounds:

**A.** Conviction of the applicant of any Class A, Class B or Class C crime;

**B.** Noncompliance of the licensed premises or its use with any local zoning ordinance or other land use ordinance not directly related to liquor control;

**C.** Conditions of record such as waste disposal violations, health or safety violations or repeated parking or traffic violations on or in the vicinity of the licensed premises and caused by persons patronizing or employed by the licensed premises or other such conditions caused by persons patronizing or employed by the licensed premises that unreasonably disturb, interfere with or affect the ability of persons or businesses residing or located in the vicinity of the licensed premises to use their property in a reasonable manner;

**D.** Repeated incidents of record of breaches of the peace, disorderly conduct, vandalism or other violations of law on or in the vicinity of the licensed premises and caused by persons patronizing or employed by the licensed premises;

**D-1.** Failure to obtain, or comply with the provisions of, a permit for music, dancing or entertainment required by a municipality or, in the case of an unincorporated place, the county commissioners;

**E.** A violation of any provision of this Title;

**F.** A determination by the municipal officers or county commissioners that the purpose of the application is to circumvent the provisions of section 601; and



G. After September 1, 2010, server training, in a program certified by the bureau and required by local ordinance, has not been completed by individuals who serve alcoholic beverages.

**3. Appeal to bureau.** Any applicant aggrieved by the decision of the municipal officers or county commissioners under this section may appeal to the bureau within 15 days of the receipt of the written decision of the municipal officers or county commissioners. The bureau shall hold a public hearing in the city, town or unincorporated place where the premises are situated. In acting on such an appeal, the bureau may consider all licensure requirements and findings referred to in subsection 2.

A. Repealed

B. If the decision appealed from is an application denial, the bureau may issue the license only if it finds by clear and convincing evidence that the decision was without justifiable cause.

4. Repealed

**5. Appeal to District Court.** Any person or governmental entity aggrieved by a bureau decision under this section may appeal the decision to the District Court within 30 days of receipt of the written decision of the bureau.

An applicant who files an appeal or who has an appeal pending shall pay the annual license fee the applicant would otherwise pay. Upon resolution of the appeal, if an applicant's license renewal is denied, the bureau shall refund the applicant the prorated amount of the unused license fee.

#### **Section IV: Terms and Conditions of Licensure as an Establishment that sells liquor for on-premises consumption in Maine**

- The licensee/applicant(s) agrees to be bound by and comply with the laws, rules and instructions promulgated by the Bureau.
- The licensee/applicant(s) agrees to maintain accurate records related to an on-premise license as required by the law, rules and instructions promulgated or issued by the Bureau if a license is issued as a result of this application.
  - The licensee/applicant(s) authorizes the Bureau to obtain and examine all books, records and tax returns pertaining to the business, for which this liquor license is requested, and also any books, records and returns during the year in which any liquor license is in effect.
- Any change in the licensee's/applicant's licensed premises as defined in this application must be approved by the Bureau in advance.
- All new applicants must apply to the Alcohol and Tobacco Tax and Trade Bureau (TTB) for its [Retail Beverage Alcohol Dealers](https://www.ttb.gov/nrc/retail-beverage-alcohol-dealers) permit. See the TTB's website at <https://www.ttb.gov/nrc/retail-beverage-alcohol-dealers> for more information.

## Section V: Fee Schedule

**Filing fee required.** In addition to the license fees listed below, a filing fee of \$10.00 must be included with all applications.

**Please note:** For Licensees/Applicants in unorganized territories in Maine, the \$10.00 filing fee must be paid directly to County Treasurer. All applications received by the Bureau from licensees/applicants in unorganized territories must submit proof of payment was made to the County Treasurer together with the application.

<b>Class of License</b>	<b>Type of liquor/Establishments included</b>	<b>Fee</b>
<b>Class I</b>	<b>For the sale of liquor (malt liquor, wine and spirits)</b> This class includes: Airlines; Civic Auditoriums; Class A Restaurants; Clubs with catering privileges; Dining Cars; Golf Courses; Hotels; Indoor Ice-Skating Clubs; Indoor Tennis Clubs; Vessels; Qualified Caterers	\$ 900.00
<b>Class I-A</b>	<b>For the sale of liquor (malt liquor, wine and spirits)</b> This class includes only hotels that do not serve three meals a day.	\$1,100.00
<b>Class II</b>	<b>For the Sale of Spirits Only</b> This class includes: Airlines; Civic Auditoriums; Class A Restaurants; Clubs with catering privileges; Dining Cars; Golf Courses; Hotels; Indoor Ice-Skating Clubs; Indoor Tennis Clubs; and Vessels.	\$ 550.00
<b>Class III</b>	<b>For the Sale of Wine Only</b> This class includes: Airlines; Civic Auditoriums; Class A Restaurants; Clubs with catering privileges; Dining Cars; Golf Courses; Hotels; Indoor Ice-Skating Clubs; Indoor Tennis Clubs; Restaurants; Vessels; Pool Halls; and Bed and Breakfasts.	\$ 220.00
<b>Class IV</b>	<b>For the Sale of Malt Liquor Only</b> This class includes: Airlines; Civic Auditoriums; Class A Restaurants; Clubs with catering privileges; Dining Cars; Golf Courses; Hotels; Indoor Ice-Skating Clubs; Indoor Tennis Clubs; Restaurants; Taverns; Pool Halls; and Bed and Breakfasts.	\$ 220.00
<b>Class III and IV</b>	<b>For the Sale of Malt Liquor and Wine Only</b> This class includes: Airlines; Civic Auditoriums; Class A Restaurants; Clubs with catering privileges; Dining Cars; Golf Courses; Hotels; Indoor Ice-Skating Clubs; Indoor Tennis Clubs; Restaurants; Vessels; Pool Halls; and Bed and Breakfasts.	\$ 440.00
<b>Class V</b>	<b>For the sale of liquor (malt liquor, wine and spirits)</b> This class includes only a Club without catering privileges.	\$ 495.00
<b>Class X</b>	<b>For the sale of liquor (malt liquor, wine and spirits)</b> This class includes only a Class A Lounge	\$2,200.00
<b>Class XI</b>	<b>For the sale of liquor (malt liquor, wine and spirits)</b> This class includes only a Restaurant Lounge	\$1,500.00

## Section VI Premises Floor Plan

In an effort to clearly define your license premise and the areas that consumption and storage of liquor authorized by your license type is allowed, the Bureau requires all applications to include a diagram of the premise to be licensed.

Diagrams should be submitted on this form and should be as accurate as possible. Be sure to label the following areas: entrances, office area, coolers, storage areas, display cases, shelves, restroom, point of sale area, area for on-premise consumption, dining rooms, event/function rooms, lounges, outside area/decks or any other areas on the premise that you are requesting approval. Attached an additional page as needed to fully describe the premise.

*See Attached*

LOBSTERMANS WHARF

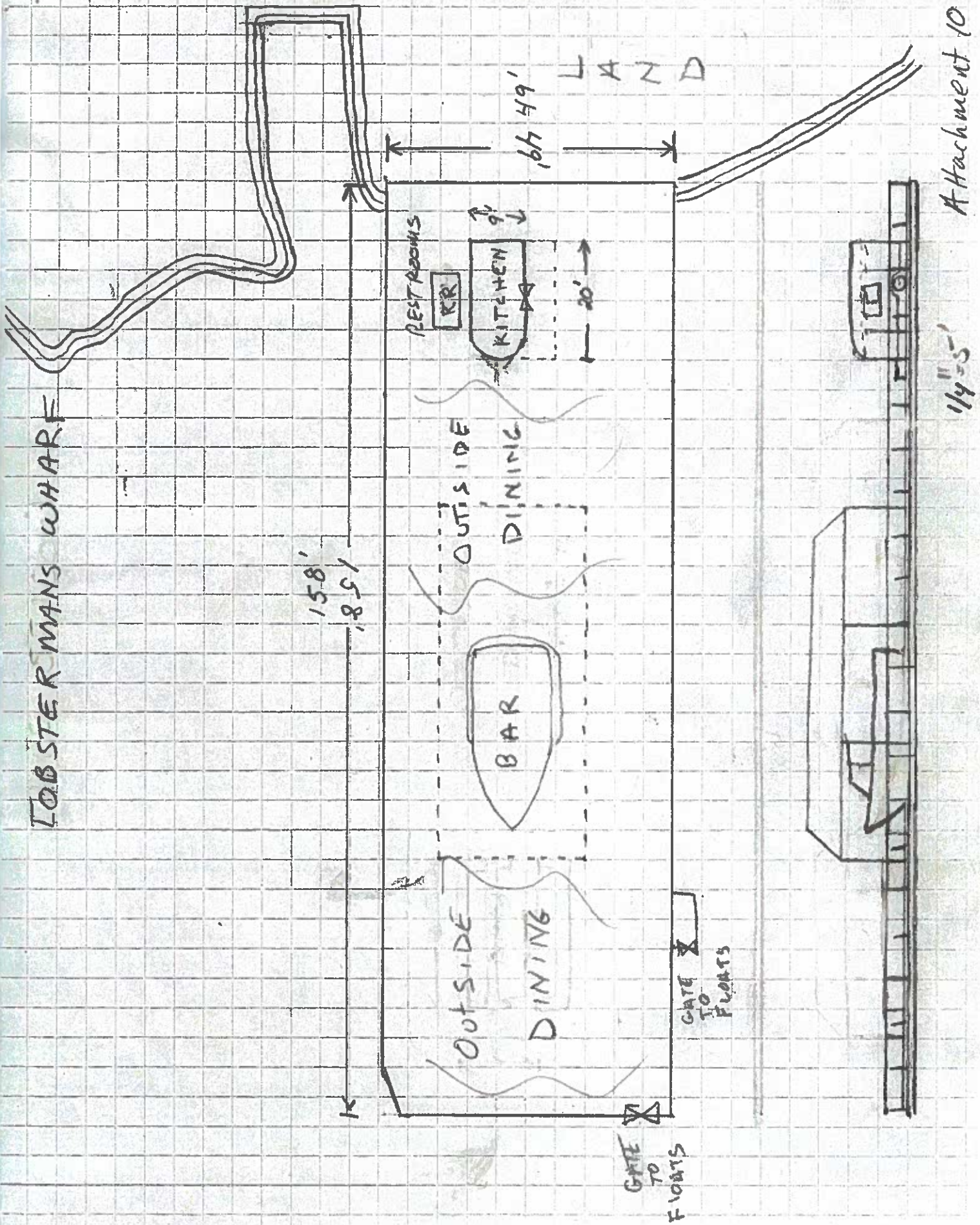



TOWN OF BOOTHBAY

SPECIAL AMUSEMENT PERMIT APPLICATION

Corporation or Business Names: Dedcz LLC dba Ocean Point Marina

Address of establishment: 216 Ocean Point Rd East Boothbay ME

Mailing address: POB 513 East Boothbay, ME 04544

Name of Application/Owner: Dan + Eileen Miller

Other owners of Business: \_\_\_\_\_

Is Application: New: \_\_\_\_\_ Renewal:  Telephone #: \_\_\_\_\_

CLASS OF LICENSE APPLIED FOR:

- Class A - Unamplified vocal or instrumental music
- Class B - Entertainment other than music
- Class C - Amplified vocal or instrumental music
- Class D - Dancing

Will admission fee be charged: Yes \_\_\_\_\_ No \_\_\_\_\_

Specifically described area to be used for entertainment purposes: On Deck +

inside banquet hall or large storage building

Schedule of Planned Entertainment: (days of the week, hours): noon-10 pm Various Days

I certify that I am familiar with the SPECIAL AMUSEMENT ORDINANCE of the Town of Boothbay as adopted on August 29, 1979, and I agree to abide with all of the conditions and regulations contained therein.

Date of application 3/21/2021

Receipt \_\_\_\_\_

Applicant's signature [Signature]  
Conditions or Restrictions: \_\_\_\_\_

Board of Selectmen - Licensing Board  
\_\_\_\_\_  
\_\_\_\_\_  
\_\_\_\_\_  
\_\_\_\_\_

Date of Hearing: \_\_\_\_\_

*paid 3/22/21*

TOWN OF BOOTHBAY

SPECIAL AMUSEMENT PERMIT APPLICATION

Corporation or Business Names: Decksz LLC dba Lobsterman's Wharf

Address of establishment: 224 Ocean Point Rd East Boothbay

Mailing address: POB 513 East Boothbay, ME 04544

Name of Application/Owner: Dan + Eileen Miller

Other owners of Business: \_\_\_\_\_

Is Application: New: \_\_\_\_\_ Renewal:  Telephone #: \_\_\_\_\_

CLASS OF LICENSE APPLIED FOR:

- Class A - Unamplified vocal or instrumental music
- Class B - Entertainment other than music
- Class C - Amplified vocal or instrumental music
- Class D - Dancing

Will admission fee be charged: Yes \_\_\_\_\_ No \_\_\_\_\_

Specifically described area to be used for entertainment purposes: On Dock

Possible Tent  
Schedule of Planned Entertainment: (days of the week, hours): noon - 10 pm Various Days

I certify that I am familiar with the SPECIAL AMUSEMENT ORDINANCE of the Town of Boothbay as adopted on August 29, 1979, and I agree to abide with all of the conditions and regulations contained therein.

Date of application  
3/21/2021

Receipt  
\_\_\_\_\_

Applicant's signature  
Daniel Miller  
Conditions or Restrictions:  
\_\_\_\_\_  
\_\_\_\_\_  
\_\_\_\_\_  
\_\_\_\_\_

Board of Selectmen - Licensing Board  
\_\_\_\_\_  
\_\_\_\_\_  
\_\_\_\_\_  
\_\_\_\_\_

Date of Hearing: \_\_\_\_\_

*paid 3/22/21*